

All dimensions are in millimetres unless otherwise stated. Do not scale from drawing. If in doubt ask.

CLIFTON COURT Basement and Ground Floor Plans		Dwg. No. (Sheet 1) Rev. B Scales (if A3) 1:100	Date August 2007 Chd. by
Title 09/06 08/07	Description A Room data added. B Room 3 deleted.	Rev.	Drawn P. K. Toyer Date August 2007 Chd. by
KEY Rotherham Metropolitan Borough Council Resources Directorate Riverside House Main Street Rotherham S60 1AE	Rotherham Metropolitan Borough Council Resources Directorate Riverside House Main Street Rotherham S60 1AE	Rotherham Metropolitan Borough Council Resources Directorate Riverside House Main Street Rotherham S60 1AE	Rotherham Metropolitan Borough Council Resources Directorate Riverside House Main Street Rotherham S60 1AE
		Strategic Director: Andrew Bedford www.rotherham.gov.uk	

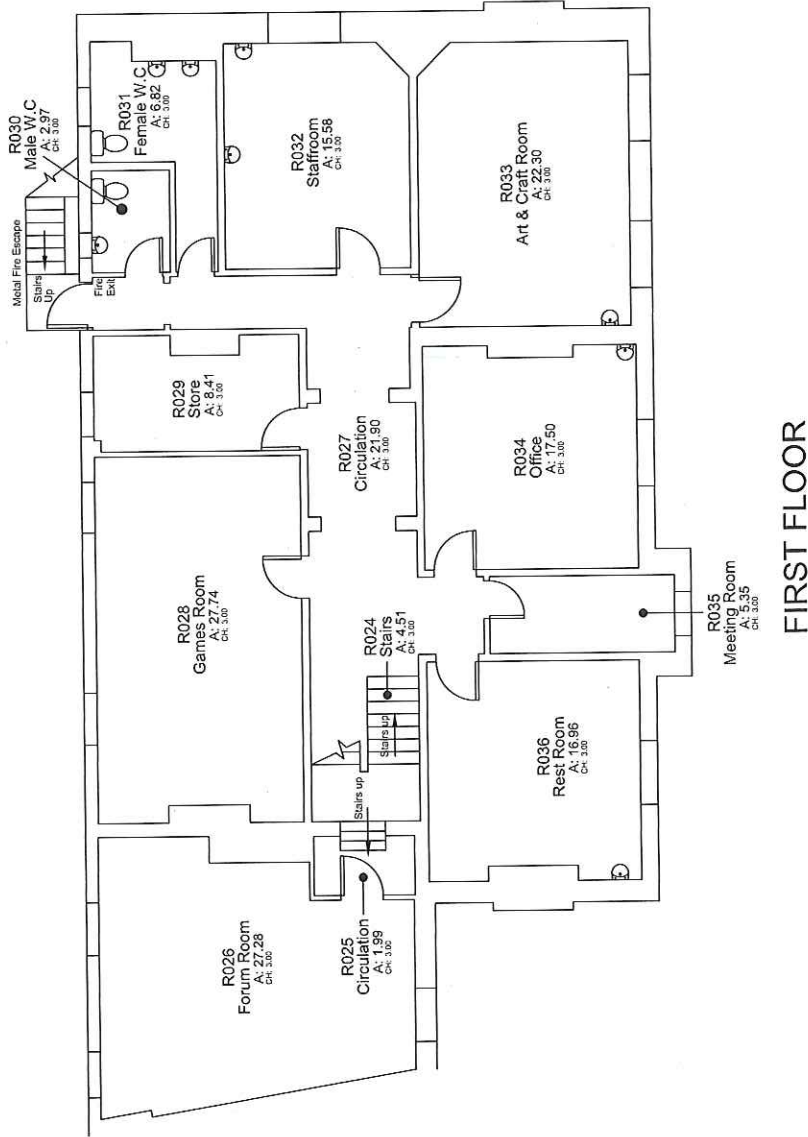

All dimensions are in millimetres unless otherwise stated. Do not scale from drawing. If in doubt ask.

<p>Room data added A Room types amended (32 & 34).</p>		<p>09/06 08/07</p>	<p>Title CLIFTON COURT First Floor Plan</p>		
<p>KEY Rotherham Metropolitan Borough Council Resources Directorate Riverside House Main Street Rotherham S60 1AE</p>		<p>Dwg. No. (Sheet 2)</p>		<p>Rev. B</p>	<p>Scales (if A3) 1:100</p>
<p>Rotherham Metropolitan Borough Council Resources Directorate Audit & Asset Management Strategic Director Andrew Radford www.rotherham.gov.uk</p>		<p>Drawn P. K. Toyer</p>		<p>Date August 2007</p>	<p>Chd. by</p>
<p>Rev.</p>		<p>Description</p>			